

Mark	Nozzle	Size	Rating	Type/Facing	Norm
N1	Inlet	1/2"	PN16	BSP (F) ISO228	EN10272
N2	Outlet	1/2"	PN16	BSP (F) ISO228	EN10272
N3	Drain	1/4"	PN16	BSP (F) ISO228	EN10272

DESIGN DATA		
Design code		EN13445:2021 (Issue 1:2021)
PED 2014/68/EU		Cat.II, mod. A2
PED phase / group		Gas / group II
Testing group		3b
Medium		Air / inert gasses
Density	kg/m3	1.33
Joint efficiency		0.85
Joint examination		RT=5% on circumferential PT=10% on nozzles (first 2 pcs. of every badge)
Cyclic loads		N.A.
Insulation		N.A.
Design pressure	Bar(g)	-1 ÷ 16
Operating pressure	Bar(g)	0 ÷ 15
Hydrostatic test	Bar(g)	25.5
Design temperature	°C	-10 ÷ 100
Operating temperature	°C	0 ÷ 90
Corrosion allowance		0
Capacity	Ltr.	20.00
Weight empty	kg	± 7.4
Weight test full	kg	± 27.4

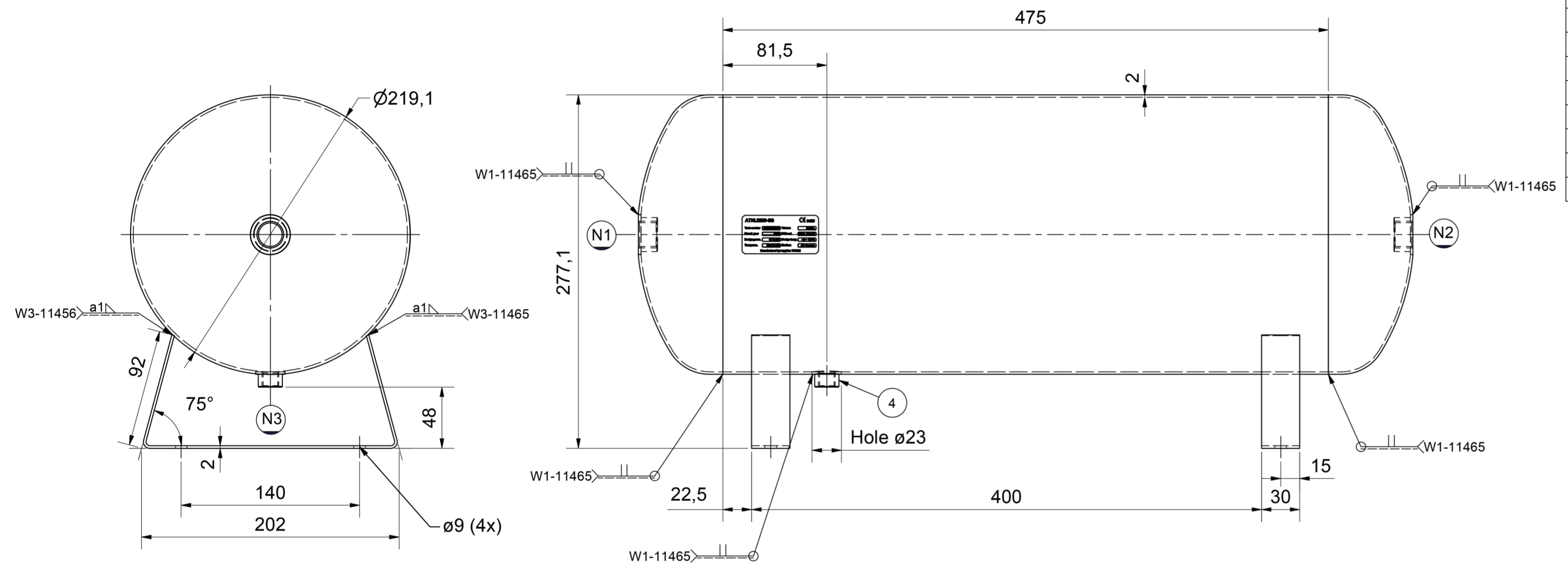
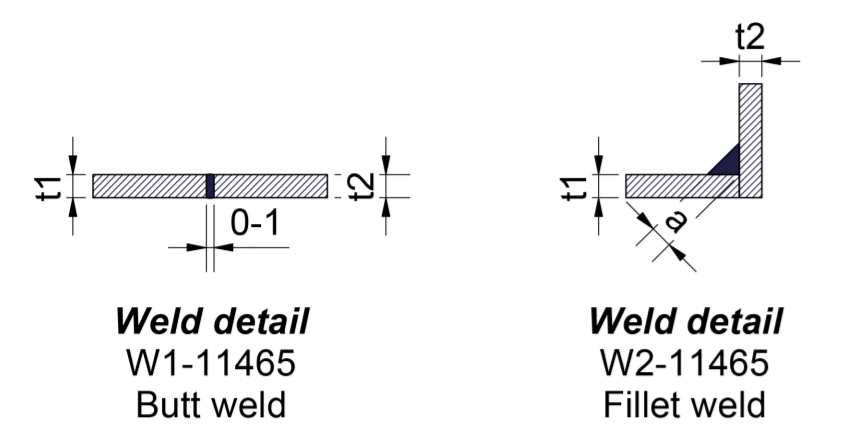

**ATNL0200-SS** CE 0408

Tank number:  Volume:

Manuf. year:  PED cat.:

Design press.:  Design temp.:

Test press.:  Medium:

Manufactured by supplier: 760022

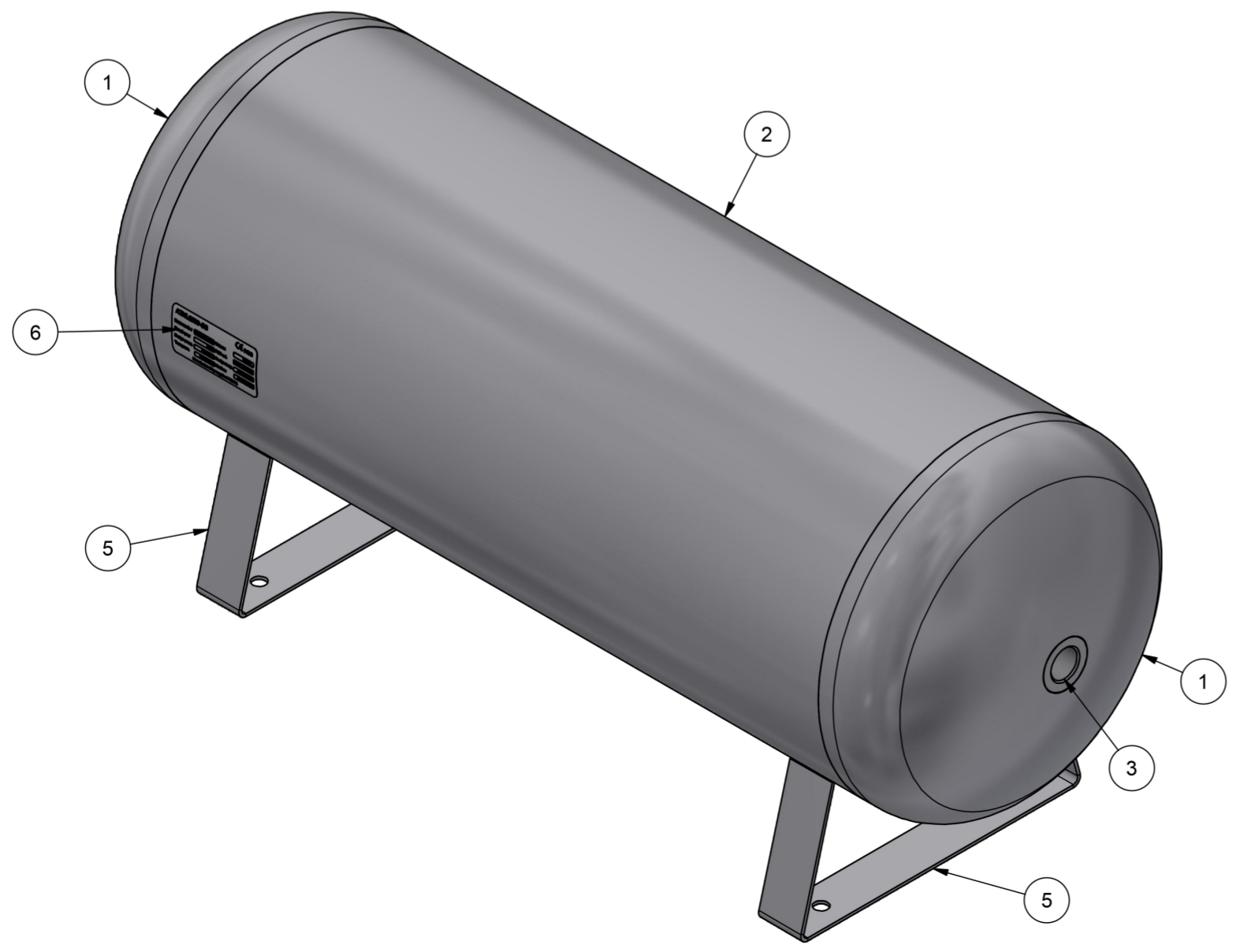

Material: 1.4301 / 1.4307  
Finish: Pickling and glass bead blasting

Scale: 1:2	Comments		
Designer:		Art.nr.:	
Date: 3-10-2022		Weight: 7,388 kg	
<b>ATNL0200-SS</b>		Ruwheid volgens NEN 3634	
		Maattoleranties volgens NEN-ISO 406	
		Vorm en plaatstoleranties volgens NEN-ISO 1101	
	INTER-TECHNICS B.V. De Sleutel 11 5652 AS Eindhoven +31 (0)88 110 9000 info@intertechnics.nl www.intertechnics.nl	Size: A2	Partnumber: -